

Important things you need to be aware of:

- Product should be placed far away from any acid material or gases;
- Avoid to test any greasy or corrosive liquid;
- Keep the exterior of this product as dry as you can when using.

## LEAKING ALARM

# USER'S GUIDE



## Introduction

This light, elegant product can easily find any leaking or sinking problems from living room, balcony and corners.

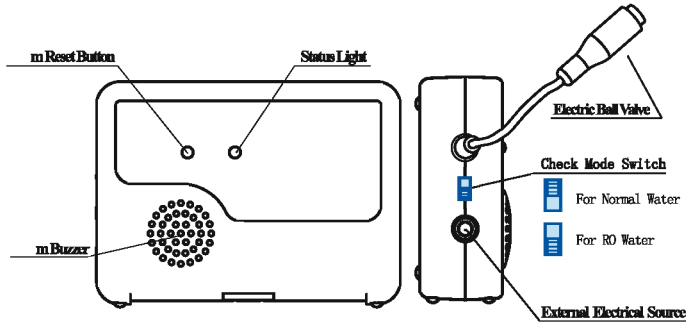

## User's guide

1. Please choose the correct mode by the mode switch showed in the picture according to the characteristic of water.

2. The  $\Phi 1$  inductor on the surface of this product can be put flatwise or sidewise; if sidewise, it's better to place it against something to keep it stable.

The buzzer will beep if there is any water leaking, and at the same time, signal from the external port of electric ball valve will drive another ball valve (can be separately purchased from the manufacturer) on the water supply pipe to cut the water supply immediately.

**Way of placement:** Please put the inductor on the ground to make it work normally.

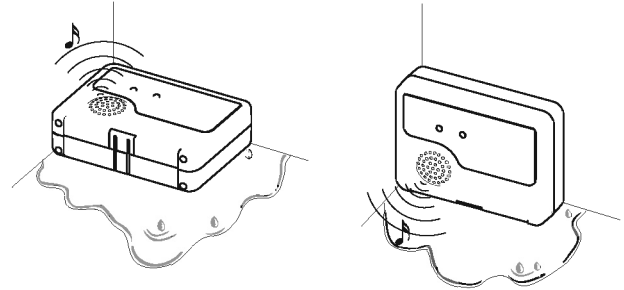

2. Pushing reset button for 3 seconds after eliminating leaking problem can reset the electric ball valve and resume water supply.

3. Yellow light shining with buzzer sound means low battery, which is to remind you to replace the battery with new one as soon as possible. This product is only compatible with 9V alkaline battery or adapter.

## Tips

The product will make wrong alarm if there is water inside it. In this situation, please take out the battery and throw the water out of the product, and then place it at the ventilation for one day or two. Please confirm that all the electric components inside are dry before using it again.